



buildings in the project will be developed by Brigham and Women's.

Members of the Roxbury nonprofit group were not immediately available to comment on their part of the project, including its cost.

Once work on the center's \$27-million Binney Street medical office building is complete and that building is occupied, plans call for a two-and-half year, \$365-million project to construct a Brigham and Women's building for medical office and research space to open within 10 years, according to design plans and Brigham and Women's spokesman Kevin Myron. Site plans also call for a 400-space, below ground parking garage, included in the \$365-million price tag, Myron said.

Mayor Thomas M. Menino and redevelopment authority Director John Palmieri joined members of the state mental health department, Brigham & Women's Hospital and Partners Healthcare Tuesday for a groundbreaking ceremony, according to an [announcement](#) from city development officials.

The project "is a unique public-private initiative of the Department of Mental Health (DMH), the Division of Capital Asset Management (DCAM) and Brigham and Women's Hospital/Partners Healthcare," said the announcement.

The project at the corner of Riverway and Fenwood Road will "create hundreds of construction jobs as well as a variety of permanent jobs," the announcement said.

To see site plans, [click here](#).

Meanwhile, *The Boston Herald* [reported](#) this week that development plans for a medical office building at nearby Brigham Circle were scaled down dramatically due to pressure from neighborhood residents and city officials.

E-mail Matt Rocheleau at [mjrochele@gmail.com](mailto:mjrochele@gmail.com).

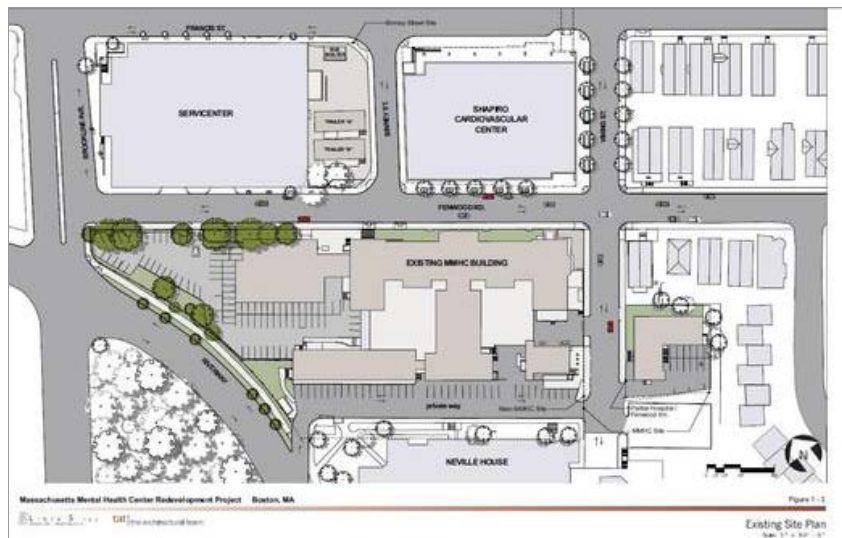

(Courtesy Boston Redevelopment Authority)

The existing Mass Mental Health Center.

Twitter | 
 Digg | 
 Like | 
 You like this. Unlike · Admin | 
 Blogger | 
 StumbleUpon

[← Previous entry](#) | [Next entry](#)

- [Franklin Park Zoo gorilla Kiki gives birth \(2 days ago\)](#)
- [Trial over, Turner returns to work on City Council \(3 days ago\)](#)
- [Colleges have demonized Four Loko, but students need to be smarter about risks \(3 days ago\)](#)



Local advertising by PaperG

### Also From Roxbury

#### SOUTH END-ROXBURY LINE



[Residents face identity crisis](#)

#### NIGHTLIFE

[Diamond in the rough](#)

#### COMMUNITY

[Fear revisits a Boston neighborhood](#)

#### EATING LOCALLY



[On the street where you live](#)

### Roxbury On Twitter

[SoWa Open Market, Boston - tomorrow \(10/31\) from 10:00am to 4:00pm - http://b.globe.com/96o3EB 7 days ago](#)

[HalloweenFest, Prudential Center, Boston - tomorrow \(10/23\) from 10:00am to 4:00pm - http://b.globe.com/cj5pwp 15 days ago](#)

[SoWa Open Market, Boston - tomorrow \(10/17\) from 10:00am to 4:00pm - http://b.globe.com/9q1U0a 21 days ago](#)

[SoWa Open Market, Boston - today \(10/3\) from 10:00am to 4:00pm - http://b.globe.com/ckpiXF 34 days ago](#)

[Follow other Boston.com Tweets](#) | [What is Twitter?](#)



READER COMMENTS »

[View reader comments \(0\)](#) » [Comment on this story](#) »



The premiere of Giacomo Puccini's opera TOSCA



Maine Fall Getaways- Over 300 Value Package!

[Home](#) | [News](#) | [Events](#) | [Schools](#) | [Sports](#) | [Discussions](#) | [Marketplace](#)

[Contact Us](#) | [Contact Boston.com](#) | [Contact The Boston Globe](#) | [Privacy Policy](#) | [Help](#) | [Advertise](#) | © 2010 NY Times Co.